

# Heavy-Duty Ball Grinding Machine SLM 72 FS

with PLC control



Spezial**M**aschinenfabrik-**S**chonungen-GmbH  
D-97453 Schonungen

# Technical Data

## Heavy-Duty Ball Grinding Machine SLM 72 FS

Working Range:	Smallest ball diameter	[mm]	2,5
	Largest ball diameter	[mm]	25,4
Compressive force control:	automatic or manual		
Machine pressure:	maximum	[kN]	70
Grinding precision:	Sphericity	according to ball diameter and DIN 5401	
	Load tolerance	according to ball diameter and DIN 5401	
Guiding disk:	Special cast iron, hardened		
Grinding disk:	Bakelit, bonded grinding wheel		
	Different coarseness		
Disk dimensions::	Outer diameter	[mm]	720
	Inner diameter	[mm]	300
	Thickness (guiding- / grinding-)	[mm]	90/75
	Speeds:	[min <sup>-1</sup> ]	10 - 90
Ring magazine:	Outer diameter	[mm]	1500
	Capacity, max.	[kg]	400
	Range of speed	[min <sup>-1</sup> ]	0,01-0,4
<b>Driving data:</b>	Total power consumption	[kW]	14,7
Main drive:	Power	[kW]	11
	Speeds	[min <sup>-1</sup> ]	1000
Ring magazine drive:	Power	[kW]	0,75
	Speed	[min <sup>-1</sup> ]	1500
Vertical adjustment of the ring magazine:	Power	[kW]	0,55
	Speeds	[min <sup>-1</sup> ]	3000/200
Ball stacker (optional):	Power	[kW]	0,12
	Speeds	[min <sup>-1</sup> ]	3000/70
Adjustment of the counter nut:	Power	[kW]	0,37
	Speeds	[min <sup>-1</sup> ]	3000/280
Pump for electrohydraulic disk adjustment, adjustment of pressure and truing device:	Power	[kW]	0,75
	Speed	[min <sup>-1</sup> ]	1500
	Conveying capacity	[l/min]	2,2
<u>Individual Coolant Tank</u>			
<u>(Special accessory)</u>			
Pump for circulation lubrication:	Power	[kW]	0,5
	Speed	[min <sup>-1</sup> ]	3000
	Conveying capacity	[l/min]	220
	Operating pressure	[bar]	0,2
Lifting pump	Power	[kW]	0,5
For coolant circulation:	Speed	[min <sup>-1</sup> ]	3000
	Conveying capacity	[l/min]	220
	Operating pressure	[bar]	0,2
Band filter drive:	Power	[kW]	0,12
	Speed	[min <sup>-1</sup> ]	1500
Drive of magnetic separator:	Power	[kW]	0,06
	Speed	[min <sup>-1</sup> ]	1500/3
Space requirement of machine:	Length x width x height	[mm]	1570x1600x2050
Weight of machine:	net	[kg]	4000
	Gross	[kg]	4400
Case measurements:	Length x width x height	[mm]	2130x1800x2400
	Volume	[m <sup>3</sup> ]	9,2

Construction modifications reserved

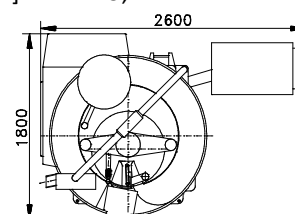

**SpezialMaschinenfabrik-Schonungen-GmbH**

Jahnstraße 6

**D-97453 Schonungen near Schweinfurt**

Telefon: (09721) 750 901 -0

Telefax: (09721) 750 901 -9

E-Mail: sms@sms-schonungen.de

Internet: www.sms-schonungen.de